

# KIN 3 ARENA MAP AND ACCESS INSTRUCTIONS

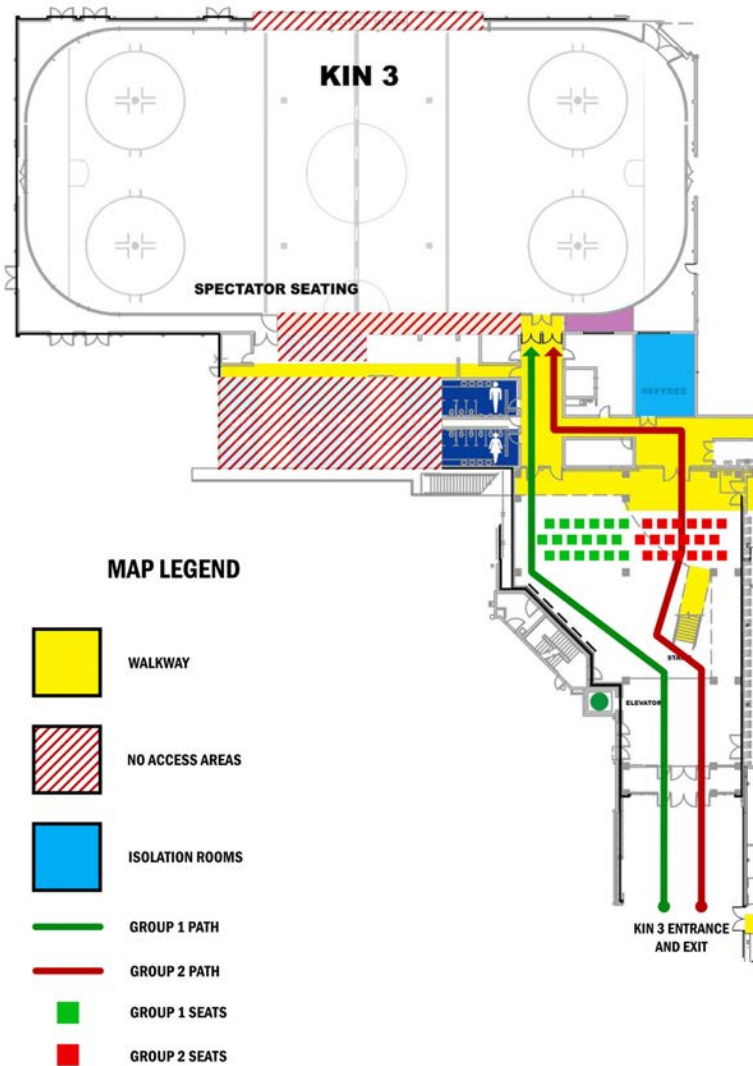

## KIN 3 ARENA ACCESS INSTRUCTIONS

- Enter the Arena through the Atrium sliding doors.
- Group 1's seating area is marked green on the map. Group 2's seating area is marked red on the map.
- Seats located in this area are for tying skates, fastening helmets, and removing skate guards.
- You may leave your belongings at your seat for later retrieval.
- Group 1 proceeds to the ice surface from the door on the left; Group 2 enters through the door on the right.
- Once your session is over, exit the Arena through the Atrium sliding doors.

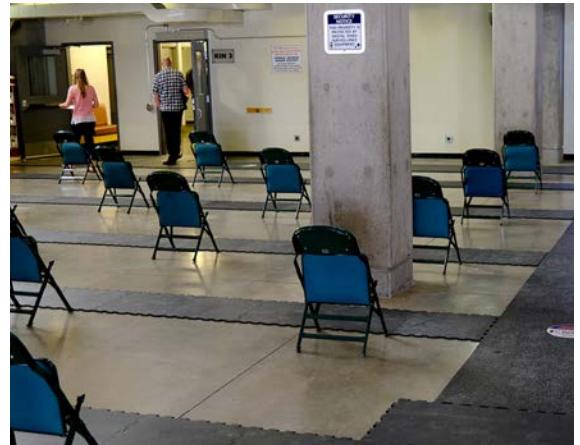

Seats in the Kin Atrium are spaced two metres apart and provide an area where participants can prepare to proceed to the ice.